

## 2.1 Mega-Pixel HD-SDI IR Dome Camera

# micron CMH001

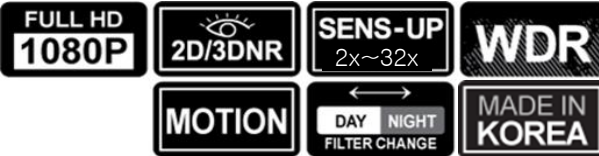

## FEATURES

- 1/2.9" 2.1 Mega-Pixel SONY CMOS sensor
- 3 Mega Pixel Lens.
- Full HD Resolution
- WDR (Wide Dynamic Range)
- DNR (Digital Noise Reduction, 2D+3D)
- Lens Shading Compensation
- Privacy mask Function
- 2.8-12mm Manual VF Lens
- 36IR LEDs
- Digital output : HD-SDI
- Analog output : Composite (without WDR)
- 3-Axis Gimbal
- DC 12V

## SPECIFICATION

ITEM	
Image Sensor	1/2.9" 2.1 Mega-Pixel SONY CMOS Sensor
Total Pixels	2000(H) x 1225(V), 2.48 Megapixel
Effective Pixels	1984(H) x 1092(V), 2.16 Megapixel
Min. Illumination	0.1 Lux without (F1.2,50 IRE,AGC MAX)
Output Video Resolution	1920x1080 30p / 25p
S/N ratio	50dB (AGC off)
Video Output	HD-SDI SMPTE 292M / 75Ω Composite BNC
Day & Night	True Day & Night (ICR)
Lens	f2.8-12mm Manual VF LENS
IR LEDs	36pcs IR LEDs
Noise Reduction	3DNR, 2DNR
DSS	2x - 32x
Shutter	AUTO, MANUAL
White Balance	AUTO /AUTOext /PRESET /MANUAL
Function	DNR, WDR, DSS MOTION DETECT, DE- Fog, PRIVCY MASK, MIRROR, BLC/HLC, D-ZOOM
OSD Language	ENGLISH, JAPANESE, CHINESE1, CHINESE2
Operating Humidity	Under 90% Non-condensing
Sub-Video Output	NTSC / PAL standard, 1.0Vpp @75Ω terminated
Power	12VDC / 560 mA LEDs ON
Operating Environment	-10°C~+50°C
HD Transmission Distance	100~150M @5C2V or RG-59 (depending on cable quality)
Protection Rating	IP66
Dimension	118(Ø) x 94(W) x 105(H) mm

Specification subject to change without notice

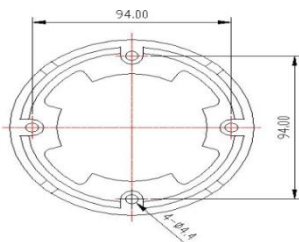
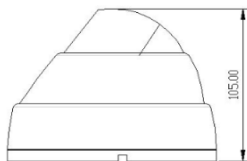
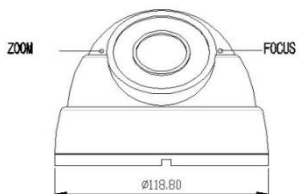

## CABLE

