

Micron Touch Screen Wi-Fi Residential Intercoms can be connected to the Internet via Wi-Fi or Ethernet cable. This allows control from your mobile device via the Micron Intercom App. **This note outlines the steps of how to connect to the Internet via- Wi-Fi and how to set up your mobile device.**

**NOTE: Intercom will only connect on a 2.4GHz Wi-Fi Network.**

## Adding a Device Using WI-FI

The monitor can connect to the Internet via WI-FI. Connecting to your Wi-Fi modem or router is done through the WI-FI settings in the monitor menu. Before you begin make sure you download the Micron Intercom + App onto your mobile device.

Then proceed to follow the instructions below.



1. Press on the setting cog to get to settings



2. Press on WI-FI



3. Press on the > alongside SSID, this will now start scanning for the 2.4GHz WI-FI



4. Once the required network is visible, press on it



5. Enter the password for the 2.4 GHz WI-FI and press the tick to save. You will know the connection is successful when the WI-FI symbol is solid.

Once the device comes online you can open the Micron Intercom + APP.

## CONNECTING ON A MOBILE DEVICE

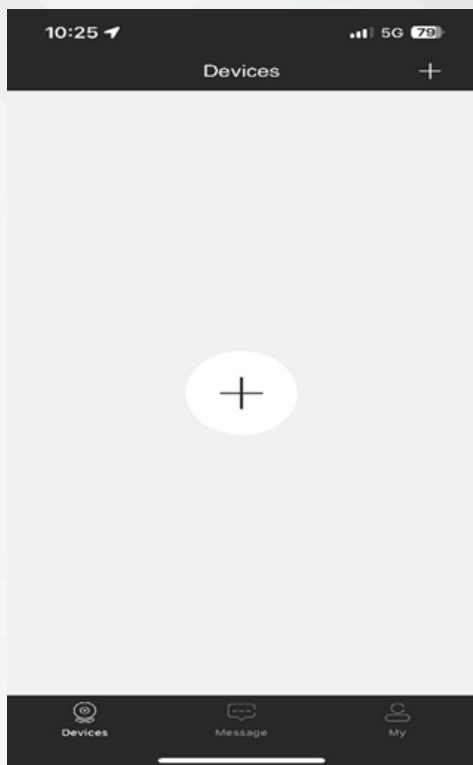

1. Press the + to add the device to the mobile. You can now scan the QR code on the WI-FI page of the intercom with your mobile device.

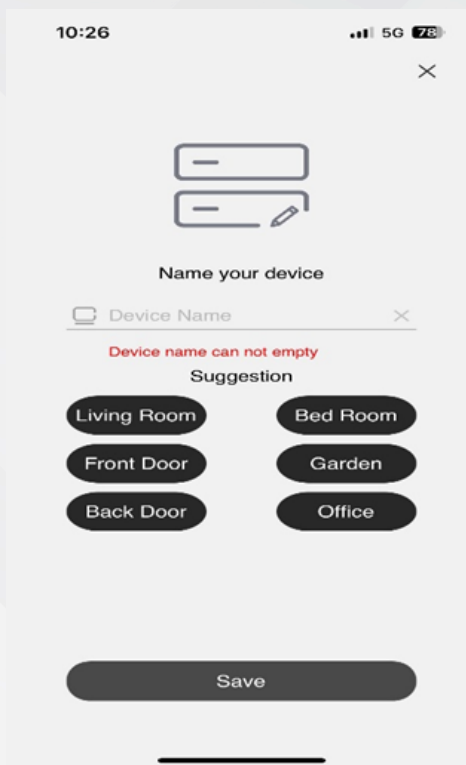

2. Once the intercom has been added, you can give the intercom a name. Press save.

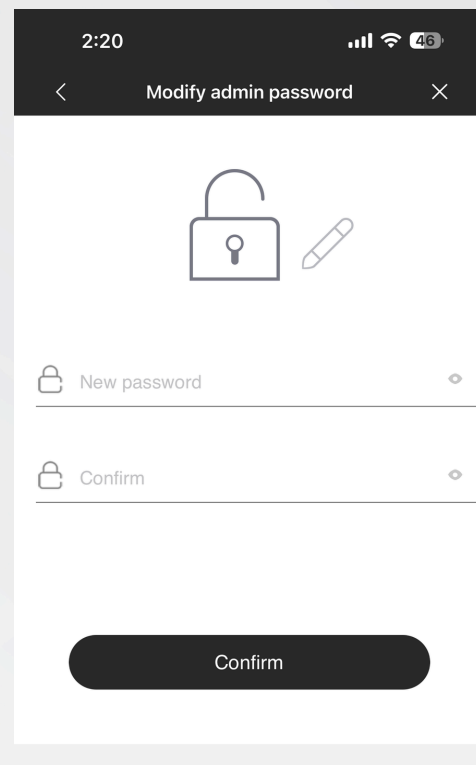

3. You will need to create a password, once created press confirm. Your intercom is now connected to the APP.

### NOTE:

- The home router must be connected to external networks if the call from door station needs to be transferred to your mobile phone.
- In order to ensure normal connection, all permissions of the APP need to be allowed.
- The QR Code of each Wi-Fi monitor is unique.

1. Download the Micron Intercoms + App, from the App Store for Mac iOS or Google Play for Android, on your mobile device.
  2. On the installed WI-FI Monitor, go to the Settings menu, select WI-FI image
  3. Press on > to Search SSID of WI-FI 2.4 GHz
  4. Once discovered press on SSID to enter WI-FI Password
  - 5 Once WI-FI is Connected, open the Micron Intercom + APP
  - 6 Press on the + symbol and scan the QR Code on the Intercom Monitor
  7. The final step is to change the intercom security pin.
- The set up is now complete.